

2.35 Male Adapter

04. Fractional Stub x ISO Tapered (M)

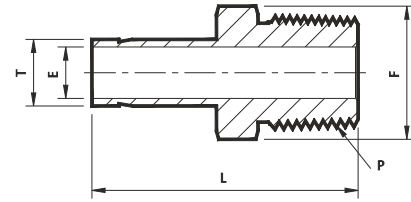

Sr. No.	TUBE OD Ø T	ISOT Male Pipe Size P	Ref. Part No.	ØE	L	Body Hex F
Dimensions in Inches						
1	1/8 x 1/8		2MAD 2IT	0.09	1.16	7/16
2	1/8 x 1/4		2MAD 4IT	0.09	1.37	9/16
3	1/4 x 1/4		4MAD 4IT	0.19	1.46	9/16
4	1/4 x 3/8		4MAD 6IT	0.19	1.44	11/16
5	1/4 x 1/2		4MAD 8IT	0.19	1.66	7/8
6	5/16 x 1/8		5MAD 2IT	0.19	1.29	7/16
7	5/16 x 1/4		5MAD 4IT	0.25	1.50	9/16
8	3/8 x 1/4		6MAD 4IT	0.28	1.53	9/16
9	3/8 x 3/8		6MAD 6IT	0.28	1.56	11/16
10	3/8 x 1/2		6MAD 8IT	0.28	1.78	7/8
11	1/2 x 1/4		8MAD 4IT	0.28	1.75	9/16
12	1/2 x 3/8		8MAD 6IT	0.38	1.78	11/16
13	1/2 x 1/2		8MAD 8IT	0.39	2.00	7/8
14	5/8 x 1/2		10MAD 8IT	0.47	2.06	7/8
15	3/4 x 3/4		12MAD 12IT	0.59	2.06	1-1/16
16	1 x 1		16MAD 16IT	0.80	2.60	1-3/8

05. Metric Stub x ISO Tapered (M)

Sr. No.	TUBE OD Ø T	ISOT Male Pipe Size P	Ref. Part No.	ØE	L	Body Hex F
Dimensions in Millimetres						
	(mm)	(Inch)				
1	6 x 1/8		6MMAD 2IT	4.6	32.8	12.5
2	6 x 1/4		6MMAD 4IT	4.6	38.1	14
3	8 x 1/4		8MMAD 4IT	6.2	39.1	14
4	8 x 3/8		8MMAD 6IT	6.4	38.3	17.4
5	10 x 1/4		10MMAD 4IT	7.1	39.9	14
6	10 x 3/8		10MMAD 6IT	7.7	40.6	17.4
7	10 x 1/2		10MMAD 8IT	7.9	44.5	22.2
8	12 x 1/4		12MMAD 4IT	7.1	46.5	14
9	12 x 3/8		12MMAD 6IT	9.1	46.2	17.4
10	12 x 1/2		12MMAD 8IT	9.1	51.8	22.2
11	16 x 1/2		16MMAD 8IT	11.9	50.8	22.2
12	18 x 3/4		18MMAD 12IT	15.1	51.6	27
13	20 x 3/4		20MMAD - 12IT	15.9	52.4	27
14	25 x 1		25MMAD - 16IT	21.8	65.9	35

NOTE : ① The E Dimension is the minimum opening & Fittings of this group may be back drilling to lager ID at pipe thread or straight thread end.
② ISO Tapered (BSPT) thread as per BS 21.

All part numbers are proprietary of their respective owners, Dimensions are for reference only and are subject to change