

2.36 Female Adapter

07. Fractional Stub x ISO Parallel (F) - Gauge

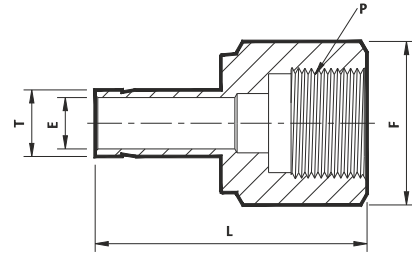

Sr. No.	TUBE OD Ø T	ISOP Female Pipe Size P	Ref. Part No.	ØE	L	Body Hex F
Dimensions in Inches						
1	1/4 x 1/4		4FAD 4IPG	0.19	1.39	3/4
2	3/8 x 3/8		6FAD 6IPG	0.26	1.55	7/8
3	1/2 x 1/2		8FAD 8IPG	0.28	1.80	1.1/16

08. Metric Stub x ISO Parallel (F) - Gauge

Sr. No.	TUBE OD Ø T	ISOP Female Pipe Size P	Ref. Part No.	ØE	L	Body Hex F
	(mm)	(in)		Dimensions in Millimetres		
1	6 x 1/4		6MFAD 4IPG	4.6	35.3	19
2	6 x 3/8		6MFAD 6IPG	4.6	38.4	22
3	6 x 1/2		6MFAD 8IPG	4.6	42.9	27
4	8 x 1/4		8MFAD 4IPG	5.5	33.0	19
5	8 x 1/2		8MFAD 8IPG	6.2	43.7	27
6	10 x 1/4		10MFAD 4IPG	5.5	34.5	19
7	10 x 1/2		10MFAD 8IPG	7.0	40.1	27
8	12 x 1/4		12MFAD 4IPG	5.5	40.1	19
9	12 x 1/2		12MFAD 8IPG	7.0	48.8	27
10	16 x 1/2		16MFAD 8IPG	7.0	49.0	27
11	18 x 1/2		18MFAD 8IPG	7.0	49.3	27

- No seal is made around the male thread. Instead, a gasket is dropped into the flat bottom in the female thread, and the end of the male threaded end exerts a load on the gasket to seal. (Use RGGD Fitting Gasket)

NOTE : ① The E Dimension is the minimum opening & Fittings of this group may be back drilling to larger ID at pipe thread or straight thread end.
② ISO Parallel (BSPP) thread as per BS 2779.